

**London Wonderground 2021
Earls Court**

Submitted Plans:

1. Site Plan - Drawing No. UB-EC-21-003
2. Underbelly Theatre (Elevations) – Drawing No. UB/EC 21-014
3. Underbelly Theatre (Stage & Seating layout) Drawing No. [blank]
4. Big Top (Elevations) – Drawing No. UB-EC 21-014
5. Big Top (1m End on Custom) – UB-EC-21-206
6. Big Top (1m End on Rake) - UB-EC-21-205
7. Big Top (Circus 1m Custom) - Drawing No. UB-EC-21-204
8. Big Top (Circus 1m on Rake) - Drawing No. UB-EC-21-203
9. Big Top (Circus Seating) - Drawing No. UB-EC-21-201
10. Big Top (End On) - Drawing No. UB-EC-21-202

Note:

Non-fixed furniture is indicative and subject to change in line with prevailing Government Covid-19 Guidance and Regulations.

Items 5 to 10 show variations of the Big Top set up.

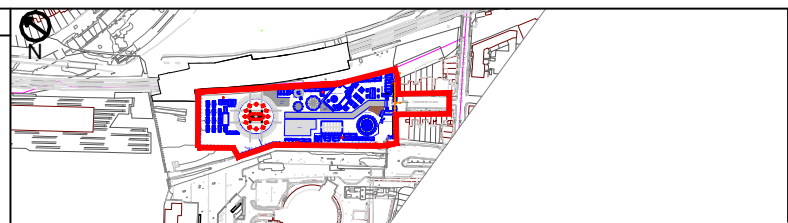
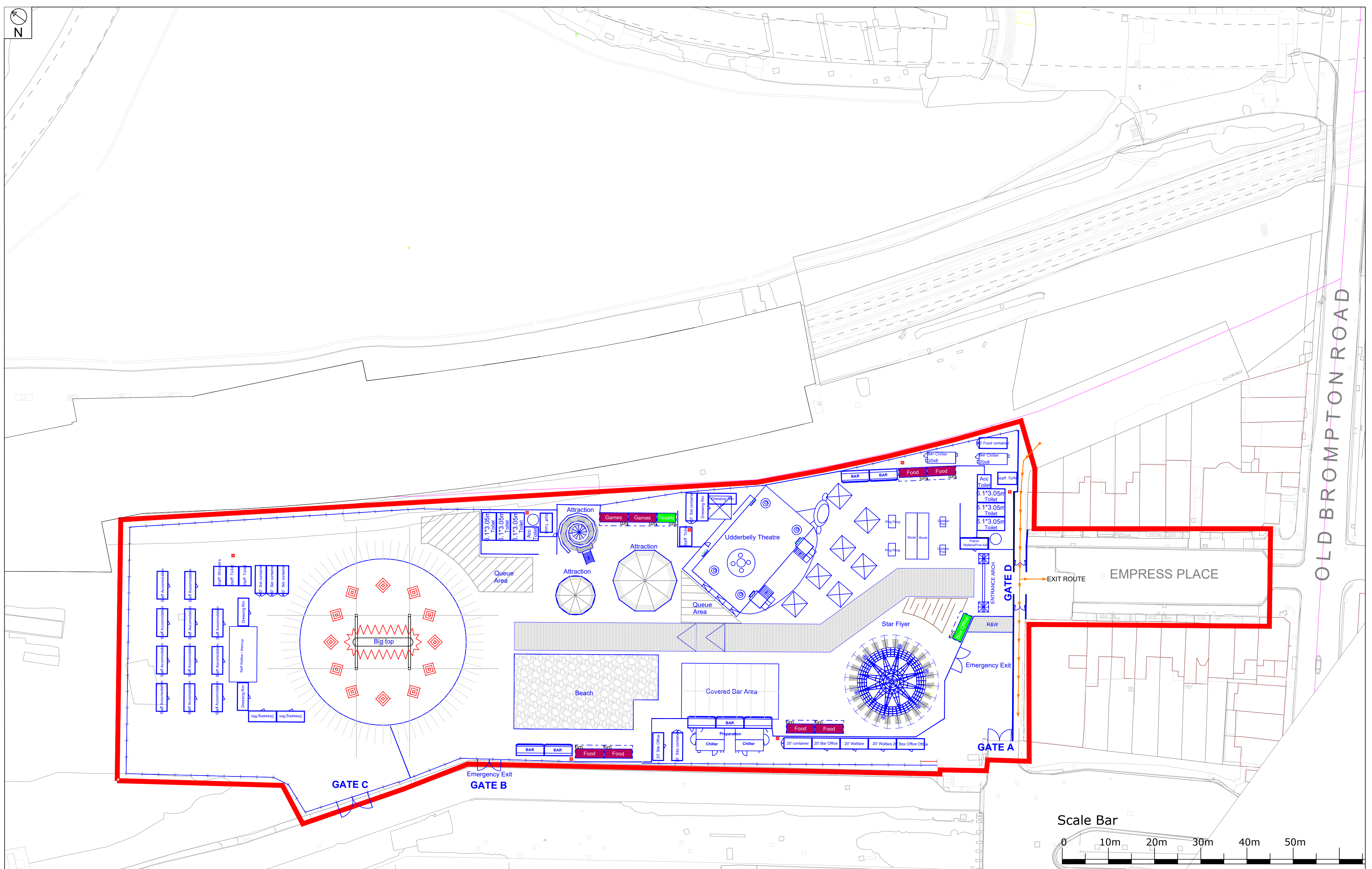

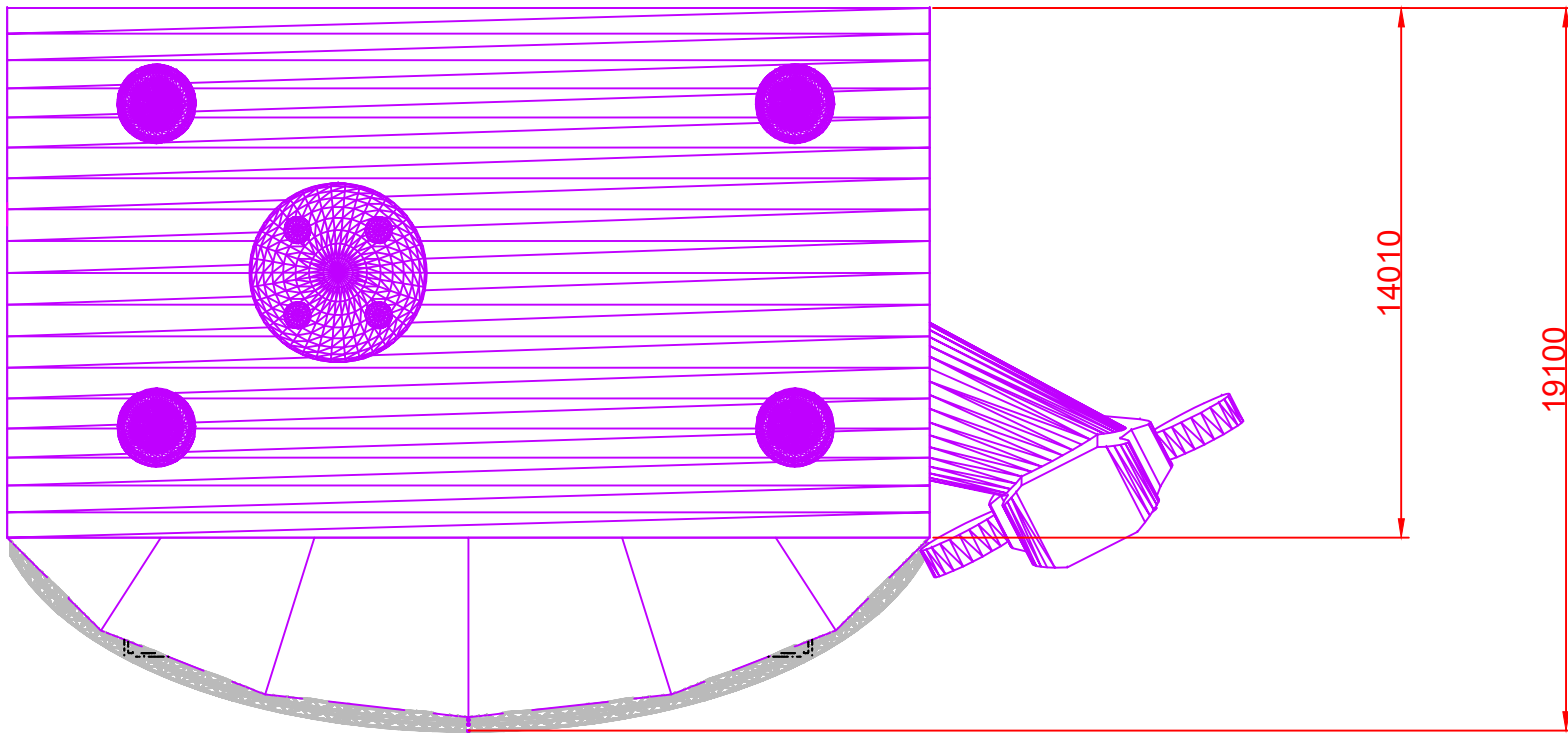

PLAN:

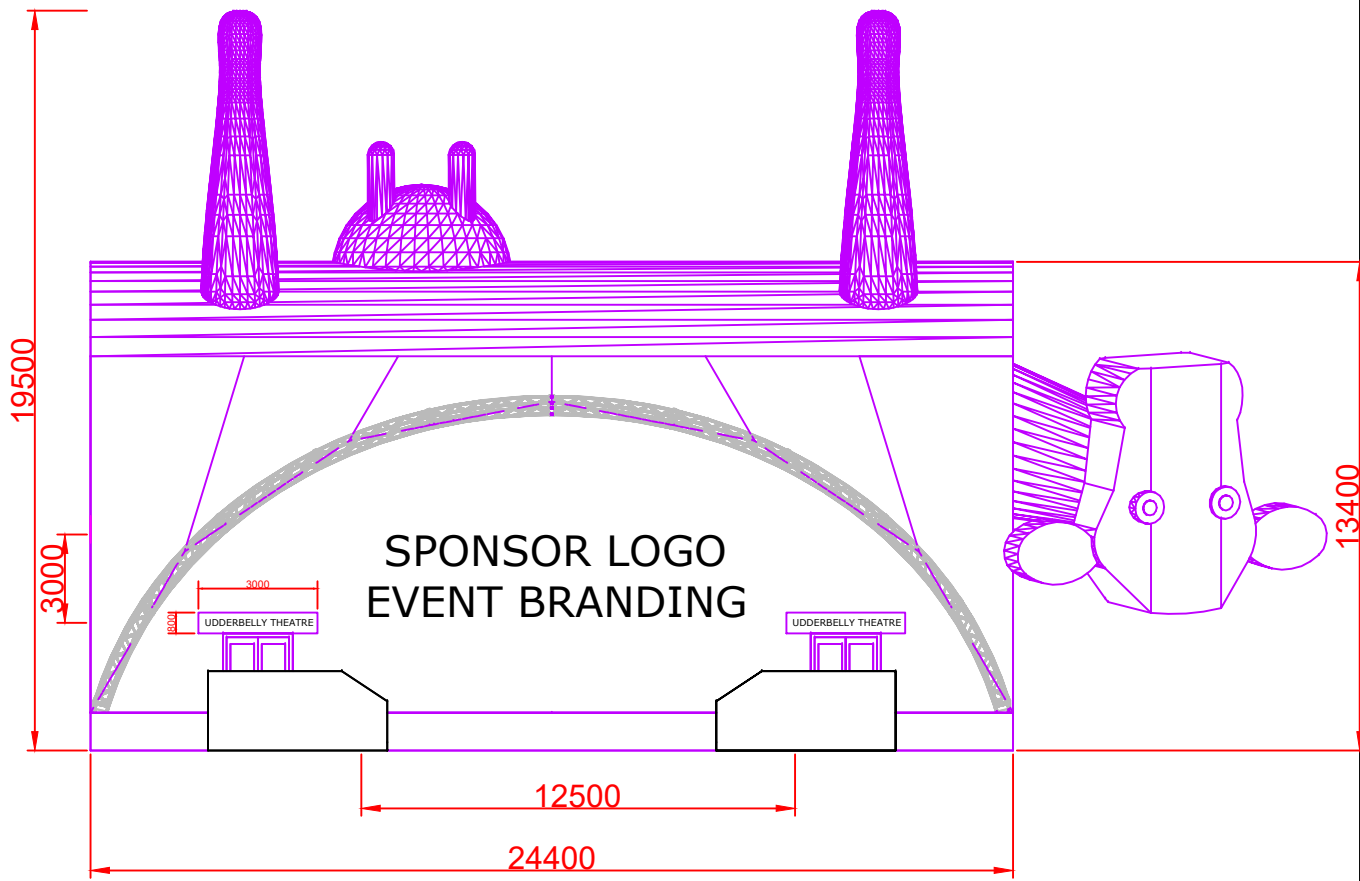

FRONT ELEVATION:

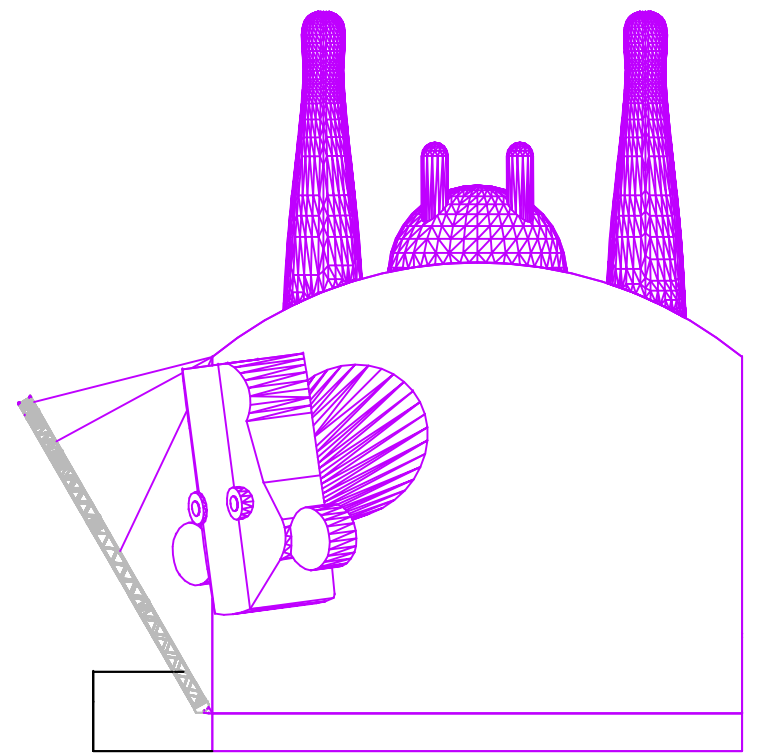

END ELEVATION:

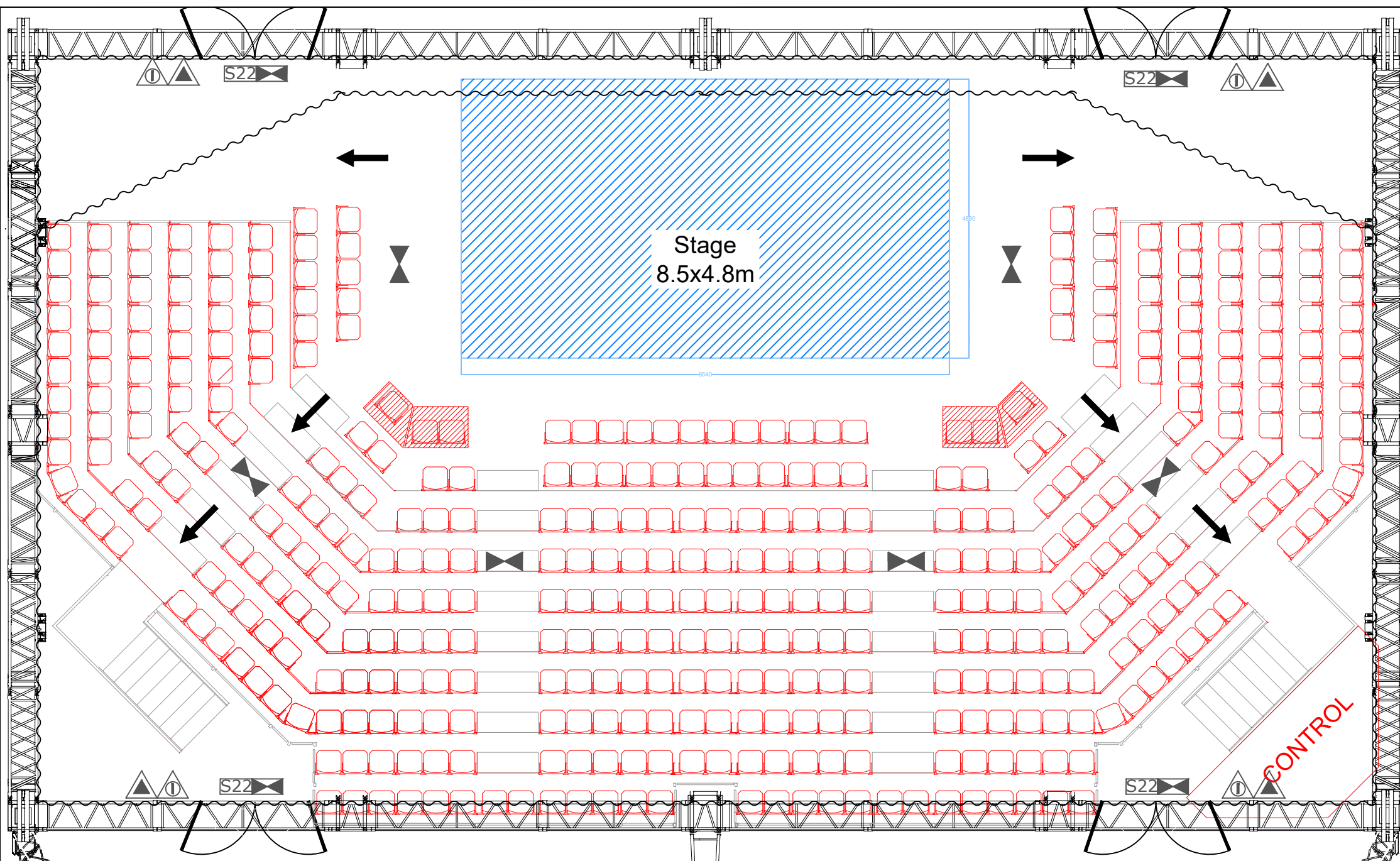



 4th floor, 36-38 Hatton Garden, London, EC1N 8EB
 Tel 0207 307 8480 - Fax 0207 307 8481 - Web www.underbelly.co.uk
 Drawing Title:
 2021 Earls Court
 Uderbelly
 Stage & seating layout

Drawn By:
 JTI
 Drawing Revised:
 14/04/2021

Drawing Number:
 Drawing Scale:
 NTS @ A4
 Drawing Date:
 16/04/2016

Notes:
 Typical Seating Layout
 410 tip-up Raked seats

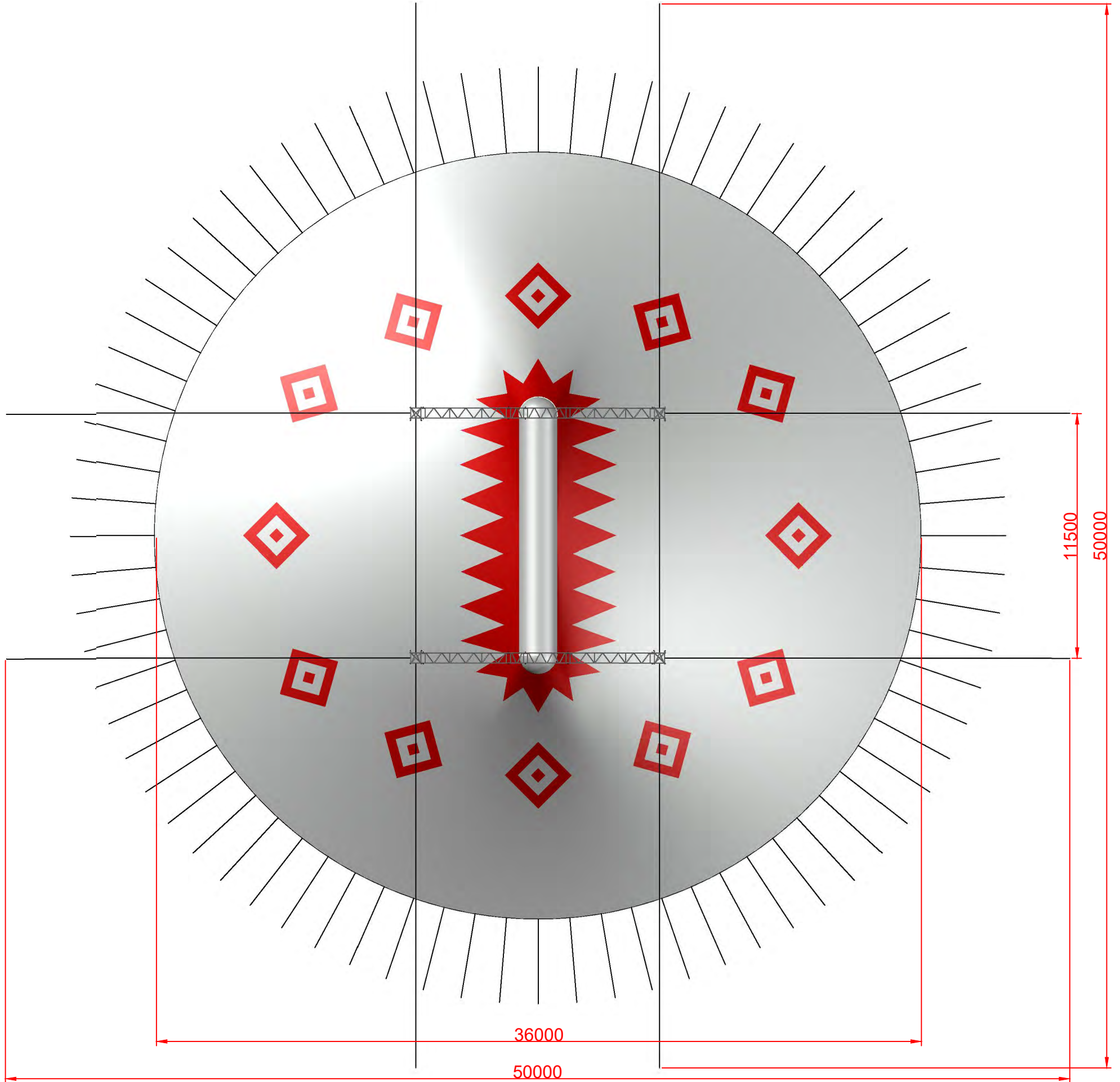
Key



PLAN:

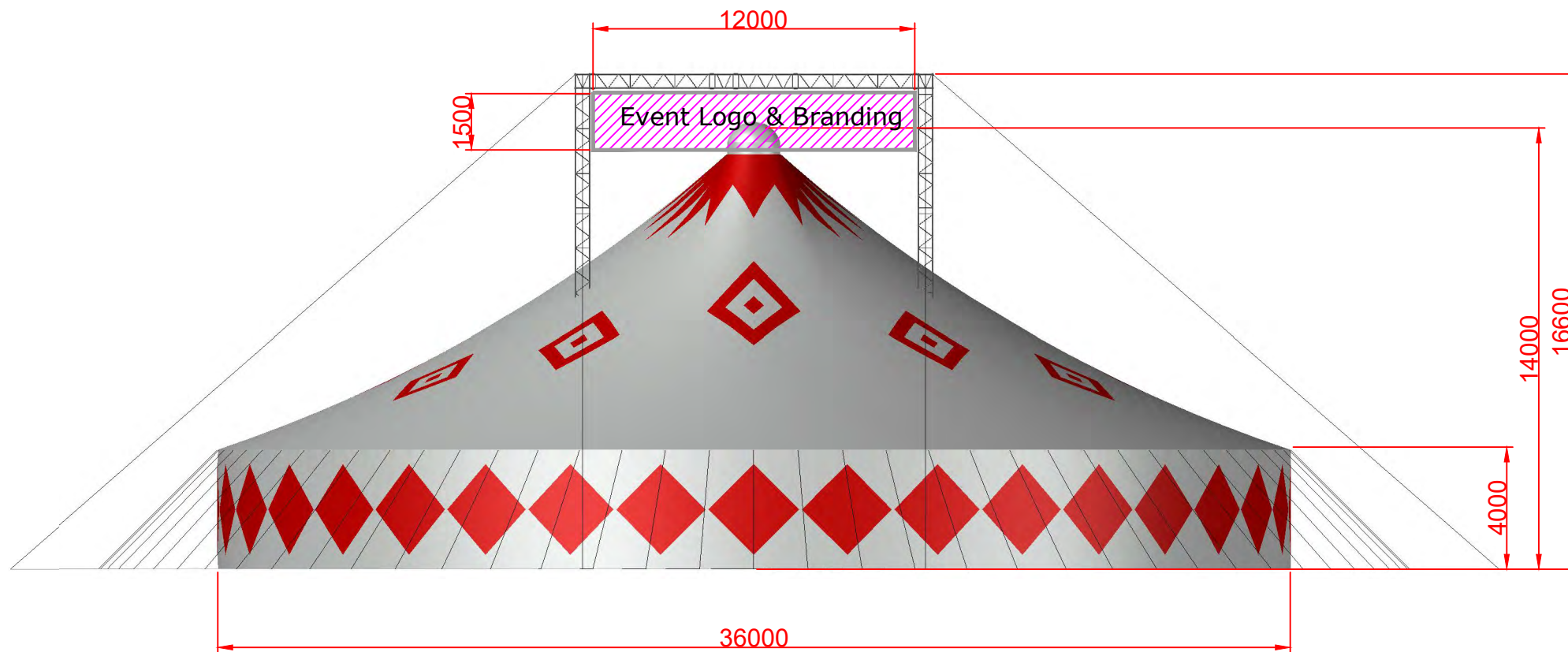

FRONT ELEVATION:



4th Floor, 36-38 Hatton Gardens, London, EC1N 8EB
Tel 0207 307 8480 - Fax 0207 307 8481 - Web www.underbelly.co.uk

Drawing Title:
Underbelly Earls Court 2021
36m Big Top Typical details

Drawn By:

Drawing Revised:

15-04-2021

Drawing Number:

UB/EC 21-014

Drawing Scale:

1:200 @ A3

Drawing Date:

08-04-2021

Notes

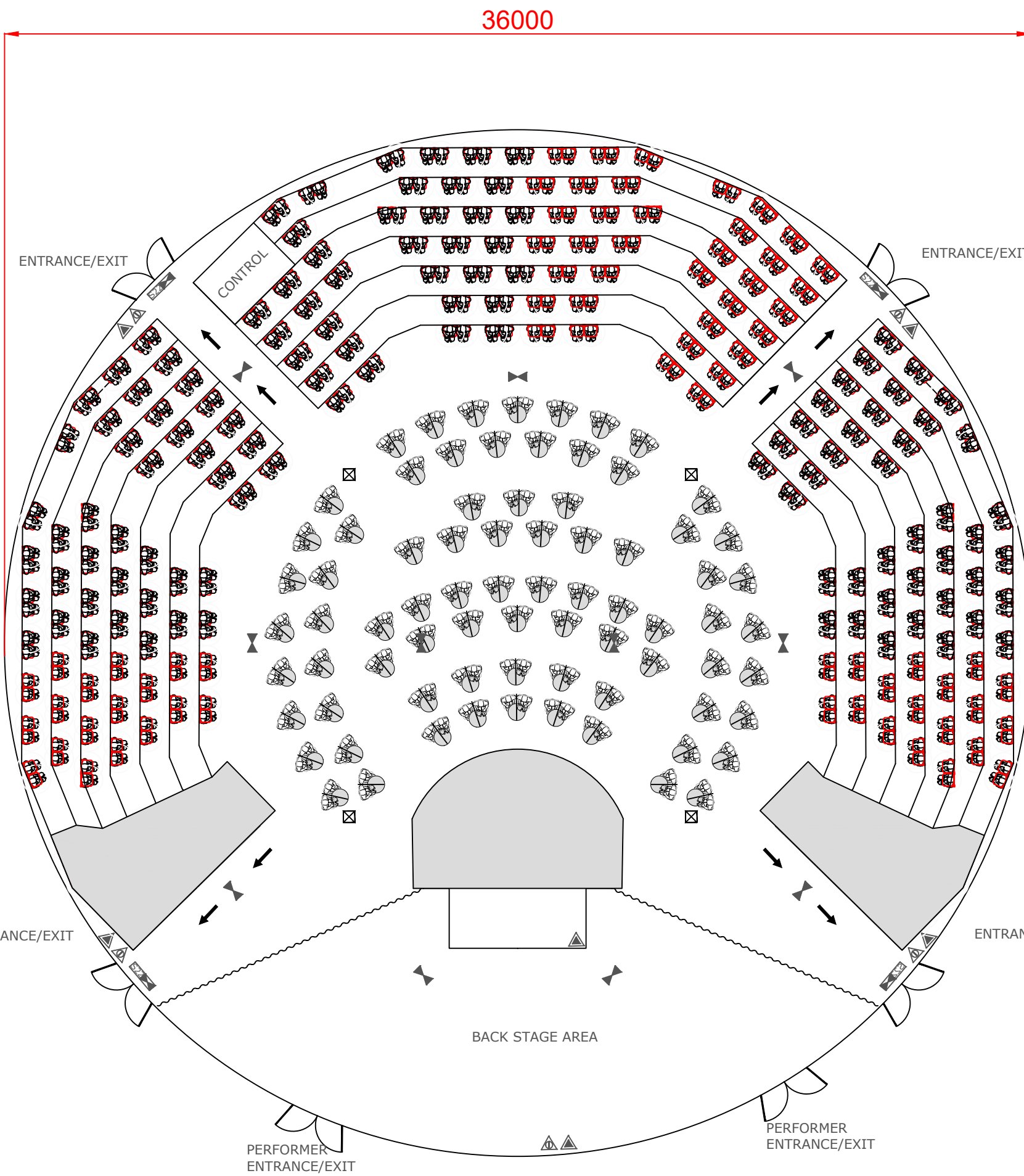

378 Raked
154 Cabaret
532 Total



4th Floor, 36-38 Hatton Gardens, London, EC1N 8EB
Tel 0207 307 8480 - Fax 0207 307 8481 - Web www.underbelly.co.uk

Drawing Title:
UNDERBELLY EARLS COURT
Big Top 1m Physical Distance
End On Seating Layout V2

Drawn By:
KE
Drawing Revised:
29-04-2021

Drawing Number:
UB-EC-21- 206
Drawing Scale:
1:NTS @ A3
Drawing Date:
30-03-2021

Notes:
Typical Circus seating layout
378 raked seats
154 cabaret seats
532 seated Capacity.